

OPERATING RANGES

Flow rates of up to:	5 m ³ /h
Max. manometric head:	50 mCE
Operating pressure:	6 bar
Max. water temperature:	+ 35°C
Max. ambient temperature:	+ 40°C
DN (nominal diameter) of port:	G1
Max. suction head :	8 m

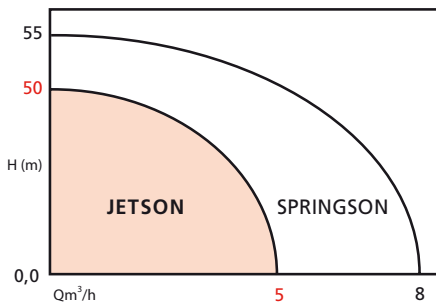

BENEFITS

- **Robust construction: 304 stainless steel impeller**
- **Ready for pumping: supplied with an electric cable (1.5 m), plug, switch and handle (P version).**
- **Over-designed motor (>100,000 cycles).**
- **Automatic priming to 8 m**

JETSON

STAINLESS STEEL, SELF-PRIMING JET PUMP 4 versions: standard, portable, automatic and hydromini 50 Hz

APPLICATION

- Distribution of clean, non-muddy water and rainwater.
- Domestic irrigation.
- Watering.
- Cleaning.

• JETSON PAC automatic version



• Hydromini Jetson



• JETSON portable version

DESIGN

• Hydraulic part

- Horizontal, venturi system, self-priming pump.
- Axial intake and vertical, upward output.
- Single-stage centrifugal.
- 304 stainless steel impeller, shaft and housing
- Sealing of shaft/motor by mechanical seal.

• Motor

- Dry, ventilated 2-pole motor.
- Single-phase: thermal protection with automatic reset.
- Capacitor integrated into the terminal box.

Speed:	2900 rpm
1~ winding:	230 V
3~ winding:	230 - 400 V.
Frequency:	50 Hz
Insulation class:	130 (B)
Protection class:	IP 44
EC conformity:	NF EN 60335-2-41
Cable:	H07Rn-F (1,5m)

SECTIONAL DRAWING

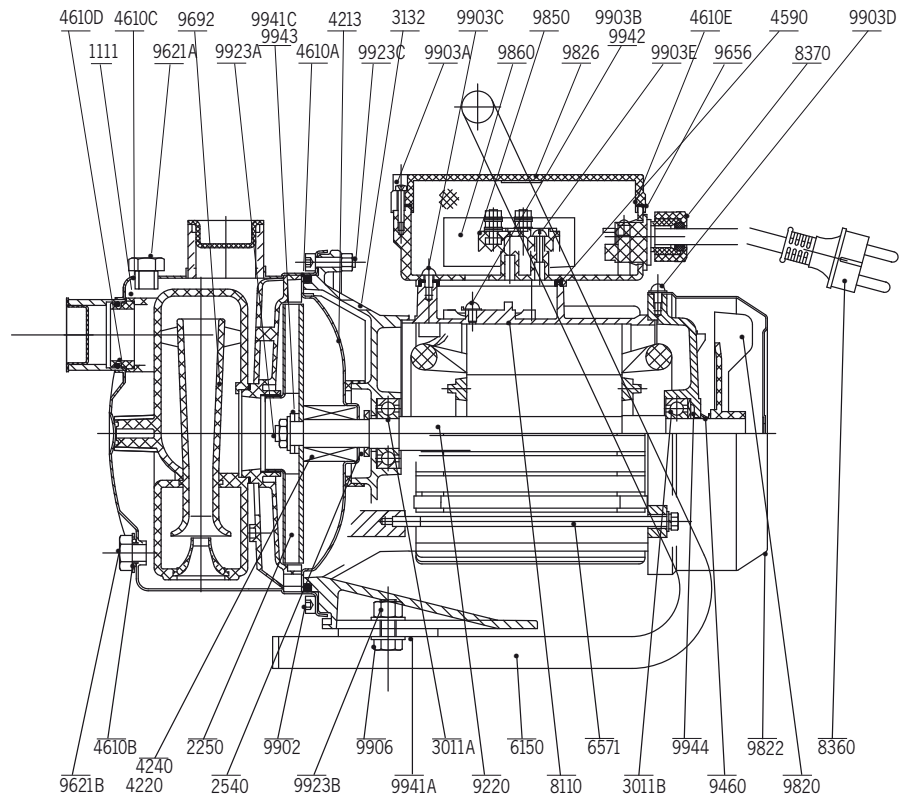

BASIC CONSTRUCTION

Main parts	Material
Housing	AISI 304 stainless steel
Impeller	AISI 304 stainless steel
Injectors	Noryl GFN 20
Diffusers	Noryl GFN 20
Shaft	AISI 304 stainless steel
Mechanical seal	Graphite/Ceramic
Gasket	NBR

PARTS LIST

- 1111 - Pump housing
 - 2250 - Impeller
 - 2540 - Deflector
 - 3011A - Front ball bearing
 - 3011B - Rear ball bearing
 - 3132 - Sleeve bearing lantern ring
 - 4213 - Throat bushing support
 - 4220 - Rotating ring I Seal
 - 4240 - Fixed ring I Mechanical
 - 4590 - Flat gasket - terminal box
 - 4610A - O-ring bottom of housing
 - 4610B - O-ring under 9621b
 - 4610c - O-ring under 9621a
 - 4610d - O-ring bottom of housing
 - 4610E - O-ring terminal box lid
 - 6150 - Handle
 - 6571 - Tie rod
 - 8110 - Motor housing with stator
 - 8370 - Cable gland
 - 9220 - Rotor shaft
 - 9460 - Lip seal
 - 9621A - Filler plug
 - 9621B - Drain plug
 - 9692 - Injector
 - 9820 - Fan
 - 9822 - Fan housing
 - 9826 - Terminal box
 - 9850 - Terminal board
 - 9860 - Capacitor
 - 9902 - Lantern ring-housing fixing screw
 - 9903A - Terminal box lid fixing screw
 - 9903B - Ground screw
 - 9903c - Terminal box fixing screw
 - 9903D - Fan housing fixing screw
 - 9903E - Terminal board fixing screw
 - 9906 - Handle fixing screw
 - 9923A - Impeller nut
 - 9923B - Handle fixing nut
 - 9923C - Lantern ring-housing fixing nut
 - 9941A - Flat washer for handle attachment
 - 9941C - Flat washer for impeller attachment
 - 9942 - Tooth lock washer under 9903b
 - 9903D - Fan housing fixing screw
 - 9943 - Split spring washer
 - 9944 - Spring washer
- (*) Recommended spare parts

HYDRAULIC PERFORMANCE

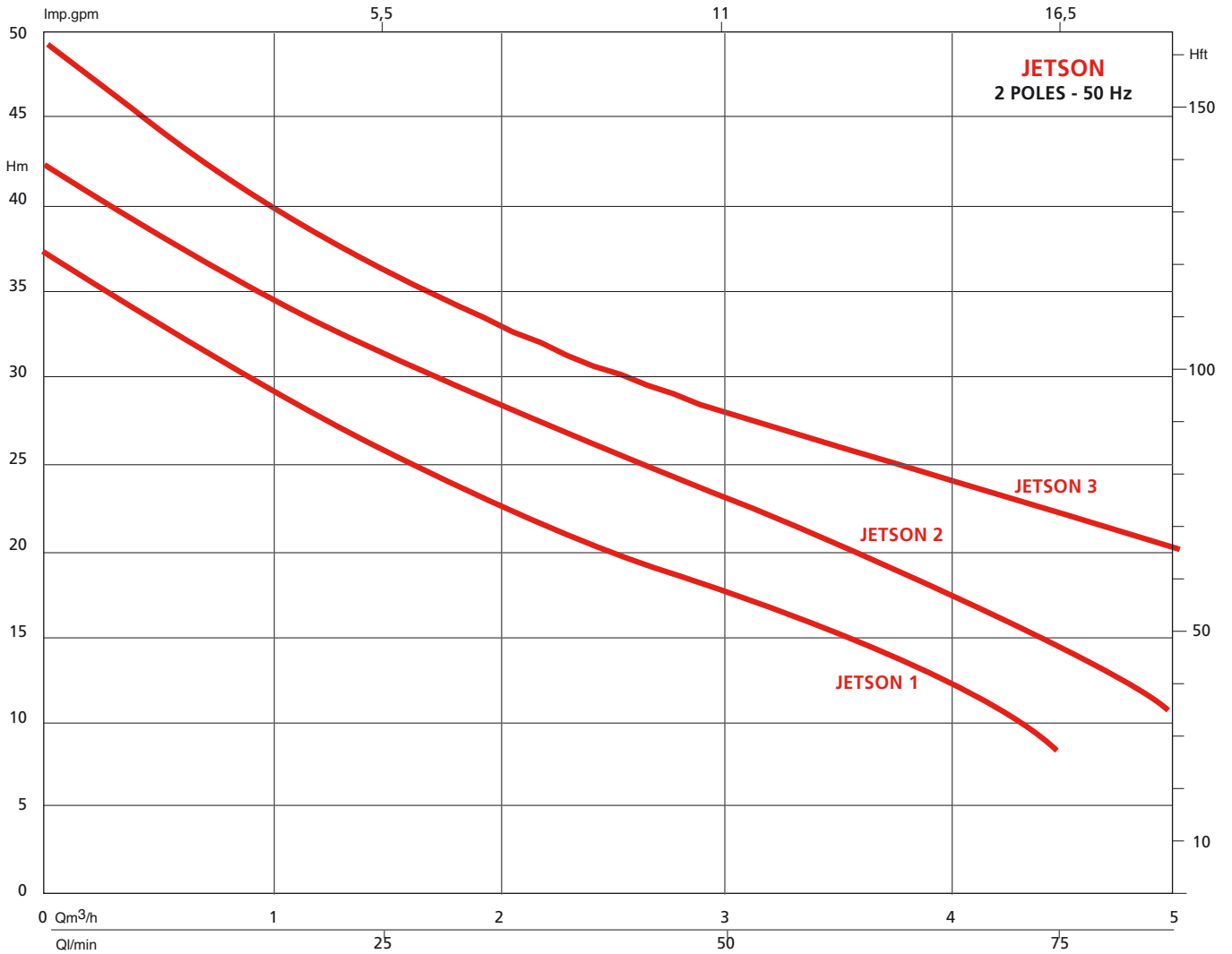

EXPLODED VIEW

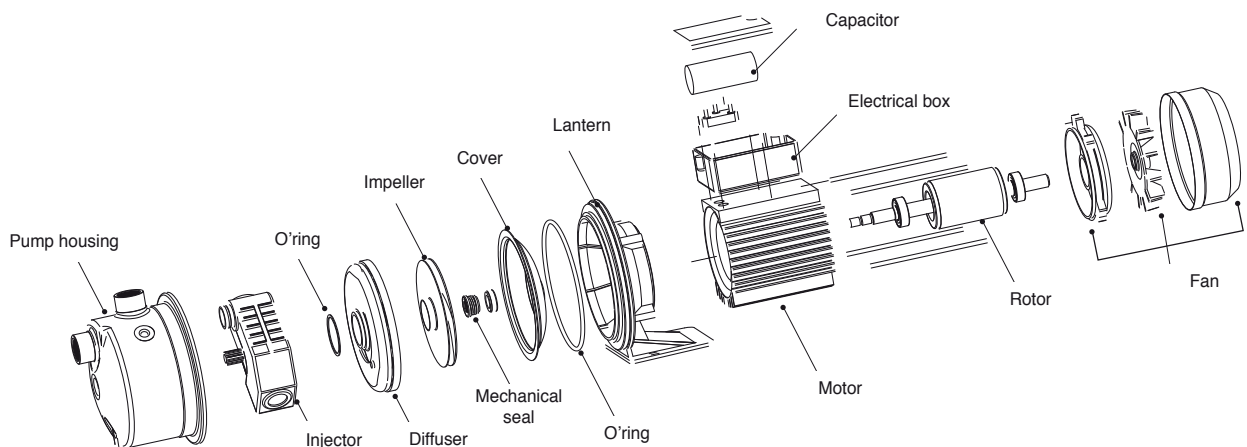

JETSON

INSTALLATION DIAGRAMS - JETSON STANDARD

•JETSON on intake

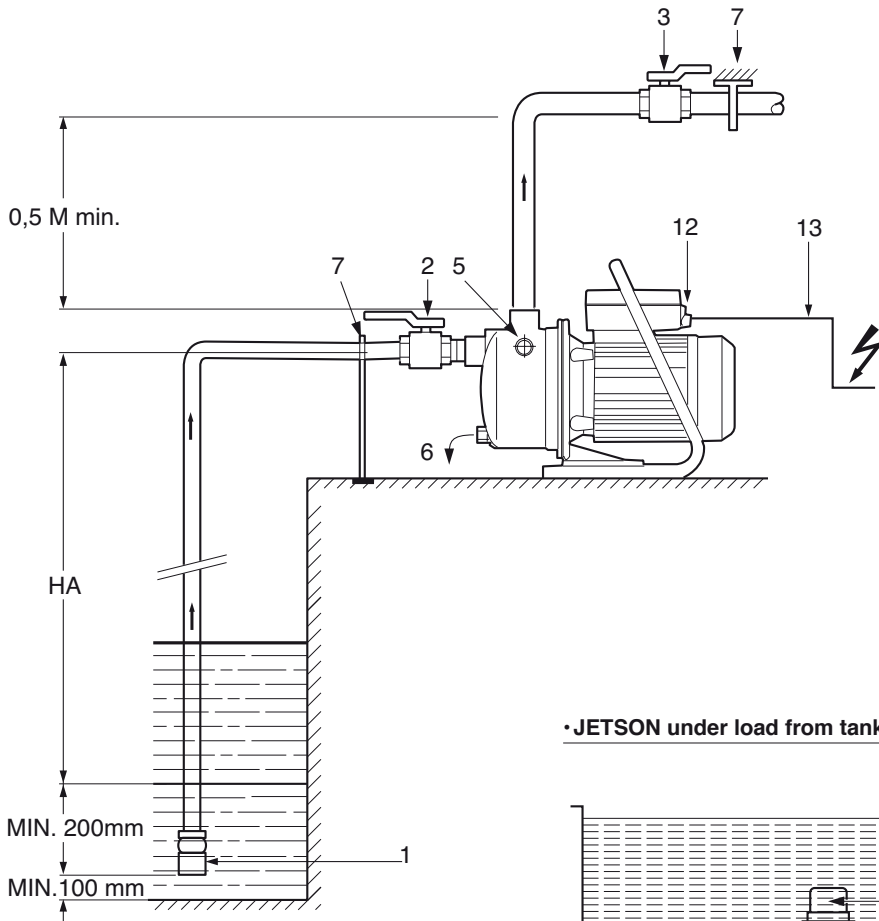

•JETSON under load from tank or mains water supply

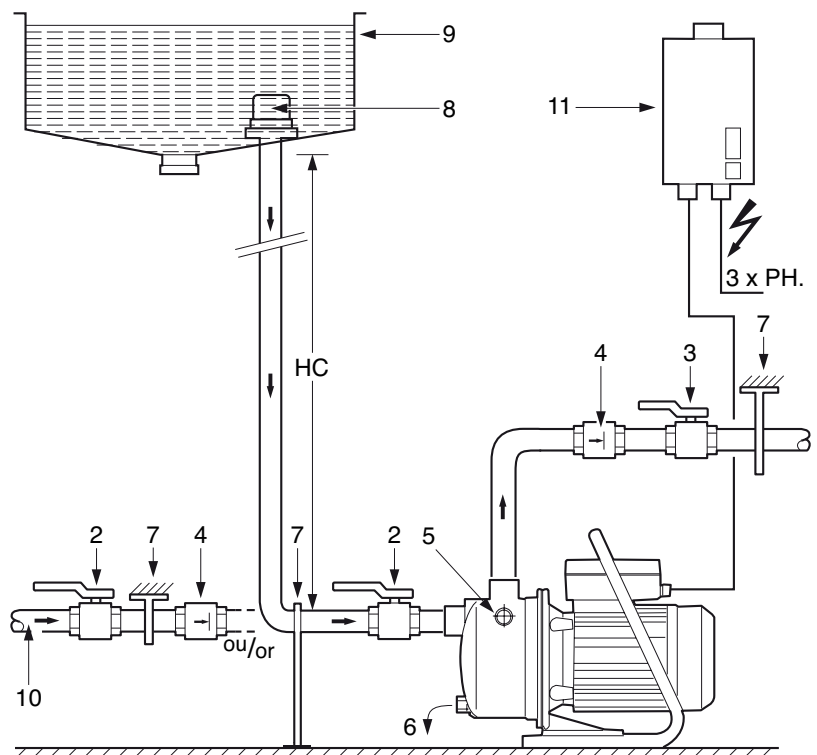

- 1: Strainer foot valve (max. flow section: 1 mm)
- 2: Pump intake valve
- 3: Pump discharge valve
- 4: Non-return valve
- 5: Filler plug
- 6: Drain plug
- 7: Pipe hanger
- 8: Strainer
- 9: Storage tank
- 10: Mains water supply
- 11: Three-phase motor protective slave switch
- 12: On/off switch in single phase (red indicator light)
- 13: Cable with plug in single phase
- HA: Suction head
- HC: Flooded head

ELECTRICAL AND DIMENSIONAL SPECIFICATIONS

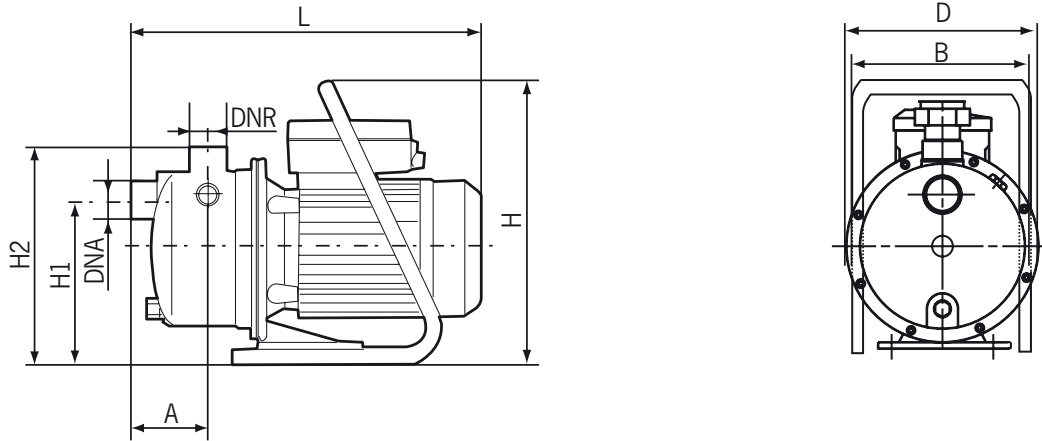

Type	A	B	H1	H2	H	D	L	DNA	DNR
JETSON-1-M-P	80	180	167,50	223	290	184	354	G1	G1
JETSON-2-M-P	80	180	167,50	223	290	184	354	G1	G1
JETSON-3-M-P	96,5	182	178,50	230,5	290	198	417	G1	G1

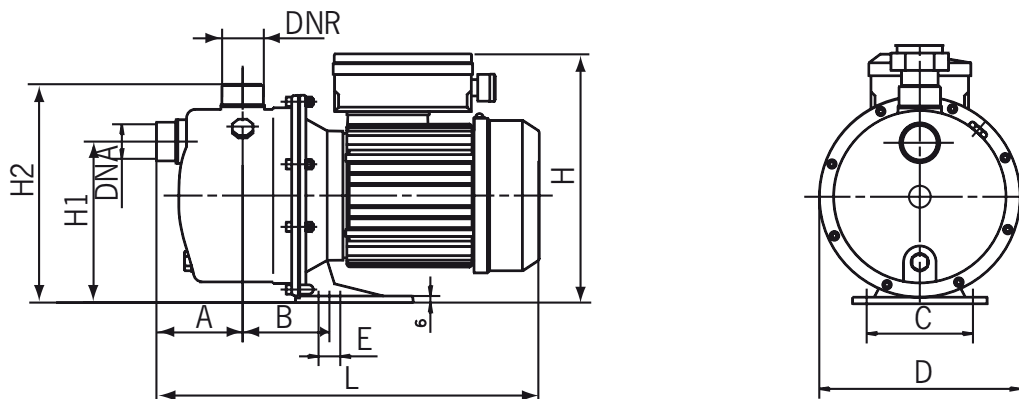

Type	A	B	C	D	E	F	H	H1	H2	L	DNA	DNR
JETSON-1-M	80	83	98	184	20	10	226	147.50	200	354	G1	G1
JETSON-2-M/T	80	83	98	184	20	10	226 / 203	147.50	200	354	G1	G1
JETSON-3-M/T	96.5	122	98	198	20	10	232 / 215	160	212	417 / 446	G1	G1

Type	MOTOR								PUMP	
	P1	Motor efficiency %			P2	Capacity (A)			Capacitor	Weight
		kW	4/4	3/4		2/4	kW	1~	3~230V	
JETSON-1-M	0.9	-	-	-	0.65	4	-	-	20	8.9
JETSON-2-M	1.2	-	-	-	0.75	5,2	-	-	20	9.9
JETSON-2-T	1.2	79.9	76	71	0.75	-	4.5	2.6	-	9.6
JETSON-1-M-P	0.9	-	-	-	0.65	3.8	-	-	20	9.6
JETSON-2-M-P	1.2	-	-	-	0.75	4.58	-	-	20	10.6
JETSON-3-M	1.3	-	-	-	1.1	6.2	-	-	30	11.2
JETSON-3-M-P	1.3	-	-	-	1.1	6.2	-	-	30	11.3
JETSON-3-T	1.2	82.2	79.5	74.7	1.1	-	4.5	2.6	-	13.5

JETSON PAC

ACSON SPECIFICITIES

Automation

When a tap is turned on, the system pressure falls and the pumps starts up immediately at the factory-preset threshold of 1.5 bar.

This threshold may be increased on site up to 3 bar according to the mains supply pressure (or HR [discharge head], HC [flooded suction height]).

The pump continues to operate for as long as there is a minimum flow rate in the system.

“Anti-water-hammer” safety device

When the tap is turned off, the pump stops automatically after a 3-5 second time lag. This time lag avoids the need to install a tank.

Low-water safety device

The automated system protects the pump from a lack of water by stopping the motor. This stoppage is shown by the activation of the “ALARM” warning light. The pump must be manually restarted via the «RESET» button.

Even when the automated system is used, all of the pump’s characteristics are maintained. The self-priming function is ensured by pressing and holding the «RESET» button during priming.



•JETSON PAC Automation

JETSON PAC INSTALLATION DIAGRAMS

•JETSON PAC under suction

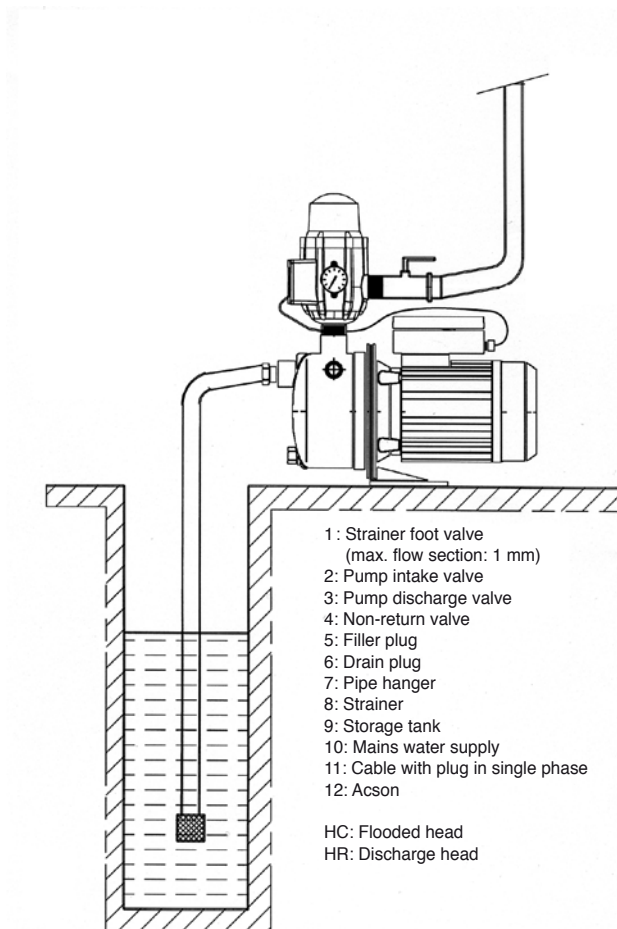

•JETSON PAC gravity-primed

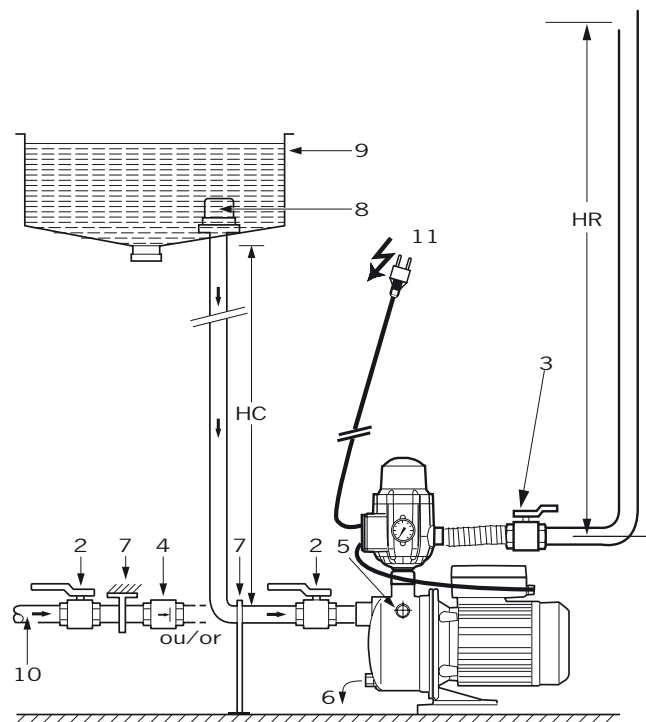

ELECTRICAL AND DIMENSIONAL SPECIFICATIONS

Produkt	MOTOR				Pump									
	Power		Current	Capacitor	type	H	L	H1	H2	L1	E	DNA	DNR	Mass
	P1	P2	MONO											
	kW	kW	A	$\mu \times 450 \text{ V}$		mm	mm	mm	mm	mm	mm	mm	mm	kg
JETSON-PAC1-M	0,87	0,65	4,1	20	JETSON-1	460	354	148	226	155	20	1"	1"	10
JETSON-PAC2-M	1	0,75	4,58	20	JETSON-2	460	354	148	226	155	20	1"	1"	10
JETSON-PAC3-M	1	1,1	4,58	20	JETSON-2	472	417	160	232	219	20	1"	1"	10

ACCESSORIES

Standard version

- Suction kit.
- Shut-off valve, strainer foot valve.
- Non-return valve.
- Bladder tank.
- Protective slave switch for three-phase motor.



• Non-return valve



• Shut-off valve

• Bladder tank



• Suction kit



• Protective slave switch for three-phase motor



PAC version

- Suction kit.
- Shut-off valves.
- Strainer foot valve.



• Shut-off valve



• Strainer foot valve



• Suction kit

Starkit G1 suction kit

- Suction kit with long hose. 7 m.
- Strainer foot valve.
- 2 intake/delivery connectors.

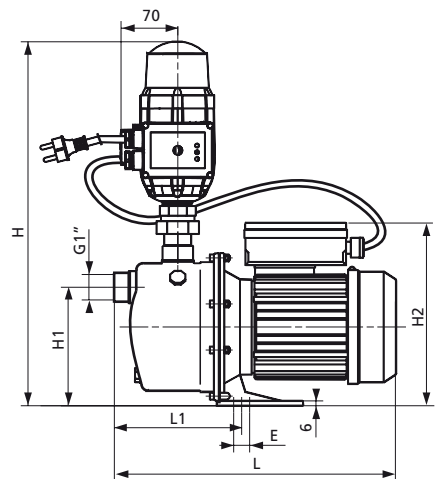

FEATURES

a) Electrical

- 230 V - 50 Hz (M) single-phase, with integrated thermal protection and automatic resetting.
- Capacitor integrated into the terminal box.
- 230 - 400 V - 50 Hz (T) three-phase, motor protection essential for differential circuit-breaker (standard version).

Provide a switch and low-water protection box in both single-phase and three-phase.

b) Fitting

- Fixed or mobile suction or gravity-primed installation.
- Gravity-primed installation of JETSON PAC is only possible if the static pressure in the system is ≤ 1.5 bar.
- Fixed installation via the two slots in the support cross-bar.
- Mobile (single-phase version): ensure the attachment of the intake pipe if the suction head > 4 m.
- Connection via a flexible hose with reinforcing coil, or a rigid pipe.
- Strainer recommended (\emptyset mesh: 1 mm).
- Foot valve recommended for pump in suction mode.

c) Packaging

Delivered ready for use, pre-wired with an electrical plug fitted (for single-phase) and optional handle. Equipped with an illuminated switch in the standard single-phase version.

d) Maintenance

- Repair: see recommended spare parts (*) subject to wear.

HYDROMINI JETSON

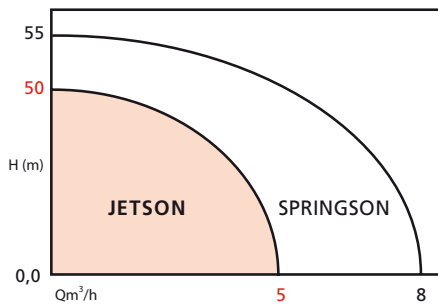

APPLICATIONS

- Recommended for:
 - Domestic pressure boosting.
 - Drip watering systems.
 - Irrigation.

OPERATING RANGES

Max. operating pressure:	6 bar
Max. temperature:	35° C
Bladder tank:	10 bar

BENEFITS

- Fully assembled and wired booster pump.
- Ready for installation, supplied with a plug and a H07RN-F cable (1.5 m).
- 20 litre or 50 litre bladder tank.
- Handy water tank to avoid frequent starting of the pump.
- Easy to use and maintain.

•Hydromini Jetson



DIMENSIONS

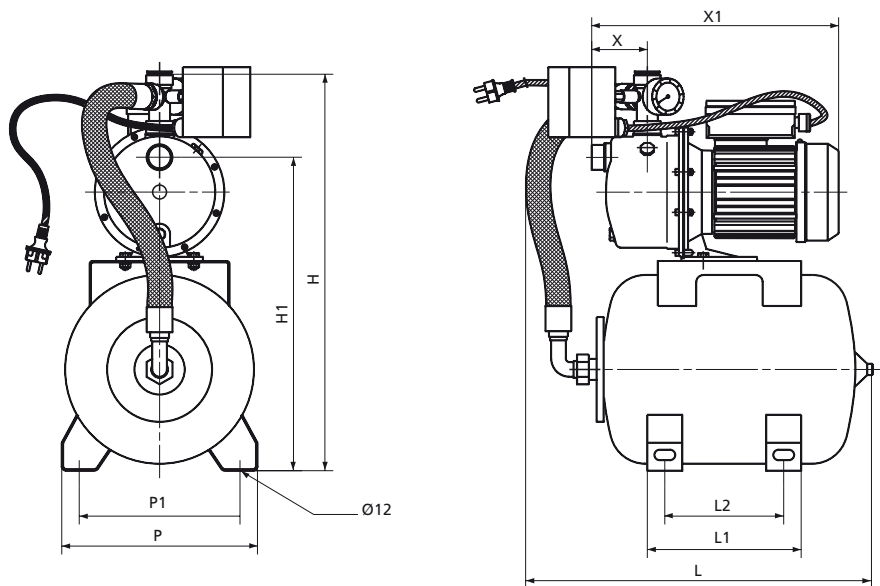

Type	H	H1	L	L1	L2	P	P1	X	X1
	mm	mm	mm	mm	mm	mm	mm	mm	mm
JETSON-1-M-H20	570	450	500	220	170	280	230	80	354
JETSON-1-M-H50	660	530	700	350	300	360	280	80	354
JETSON-2-M-H20	570	450	500	220	170	280	230	80	354
JETSON-2-M-H50	660	530	700	350	300	360	280	80	354
JETSON-3-M-H20	582	462	500	220	170	280	230	96,5	417
JETSON-3-M-H50	672	542	700	350	300	360	280	96,5	417

RECOMMENDED ACCESSORIES HYDROMINI VERSION

•Non-return valve



•Shut-off valve



•Strainer foot valve



•Suction kit

